

2. General Information

2.1. Official Fair Name

HKTDC Food Expo / HKTDC Food Expo PRO 2024

2.2. Venue

Hall 1, 3, 5
Hong Kong Convention & Exhibition Centre
Wanchai, Hong Kong

2.3. Organiser

Hong Kong Trade Development Council

Exhibitions and Digital Business Department

Unit 13, Expo Galleria, Hong Kong Convention & Exhibition Centre,
1 Expo Drive, Wanchai, Hong Kong

Telephone: (852) 2584 4333

Fax: (852) 2824 0026 / 2824 0249

Email: exhibitions@hktdc.org

Web Site: www.hktdc.com

2.4. Supporting Organization

Agricultural Trade Promotion Centre, Ministry of Agriculture and Rural Affairs of the People's Republic of China

Hong Kong & Kowloon Confectionery, Biscuit & Preserved Fruit Wholesalers Association Limited

Hong Kong & Kowloon Sauce & Preserved Fruit Amalgamated Employers Association

Hong Kong Federation of Restaurants & Related Trades Limited

Ng Fung Hong Limited

Po Sau Tong Ginseng & Antler Association Hong Kong Limited

The Hong Kong & Kowloon Provisions, Wine & Spirit Dealers' Association Limited

The Hong Kong Food Council

2.5. Fair Dates & Opening Hours

Date	Food Expo (Public Hall & Gourmet Zone)		Food Expo PRO	
15 August (Thu)	Open to public	10am - 10pm	Admission fee: HKD 100 for trade buyers. Buyers under 18 will not be admitted.	10am - 6pm
16 August (Fri)				
17 August (Sat)			Admission fee: HKD 40 for trade buyers. Open to public & trade buyers.	10am - 5pm
18 August (Sun)				
19 August (Mon)		10am - 6pm		

2.6. Visitors' Information

Food Expo PRO Trade Hall

Admission Fee is HKD\$100 per person on 15-16 August and HKD\$40 on 17 August to the trade hall during the indicated period, visitors under 18 will not be admitted to the trade hall.

Buyer Registration Counter Opening Hours:

(15-16 August): 9:30am-5:30pm

(17 August): 9:30am-3:30pm

Food Expo Public Hall

Open to public by ticket admission:

- HKD30 per visitor.
- Children under 3 and elderly over 65 will be admitted free of charge.
- There will be no admission to the fairground 45 minutes before the announced daily closing time of the expo.

Food Expo Gourmet Zone

Open to public by ticket admission:

- HKD40 per visitor. (Combo ticket); For top-up from Public Hall tickets, additional HKD10 is required at Hall 3B Entrance.
- Children under 3 and elderly over 65 will be admitted free of charge.
- There will be no admission to the fairground 45 minutes before the announced daily closing time of the expo.

2.7 Location of the Utensils Cleaning Room & Storage Area

Hall 1

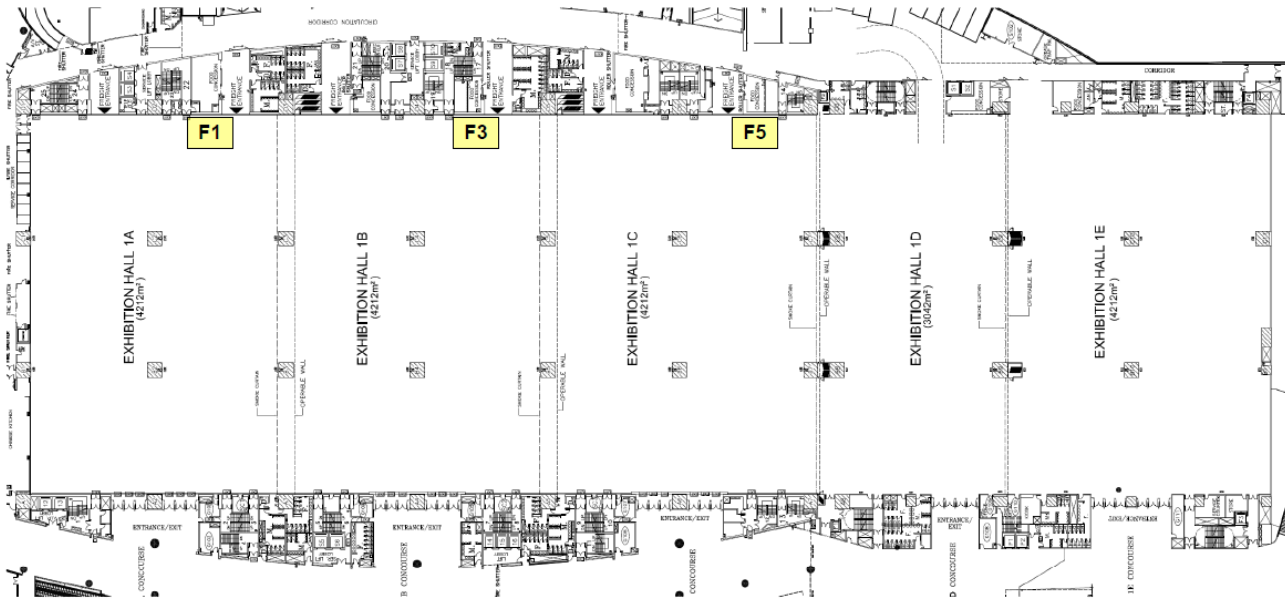

Hall 3

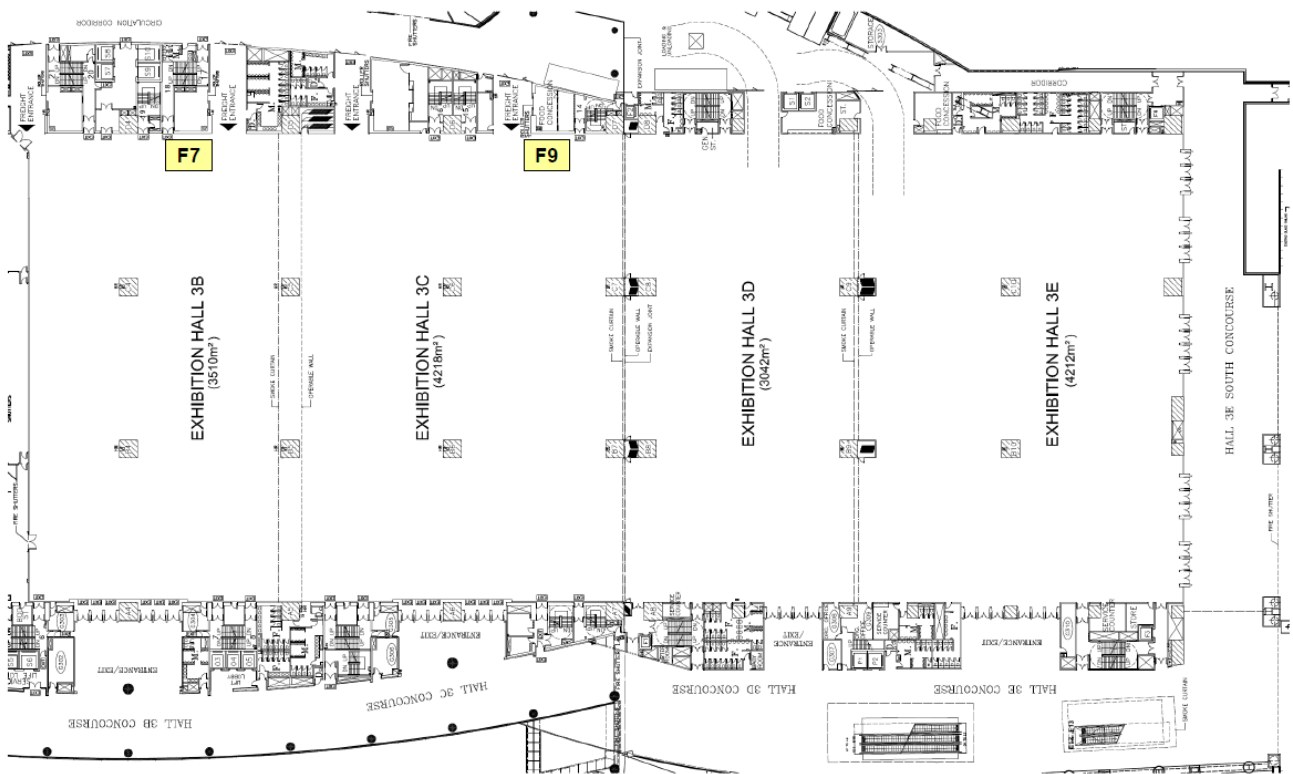

Hall 5

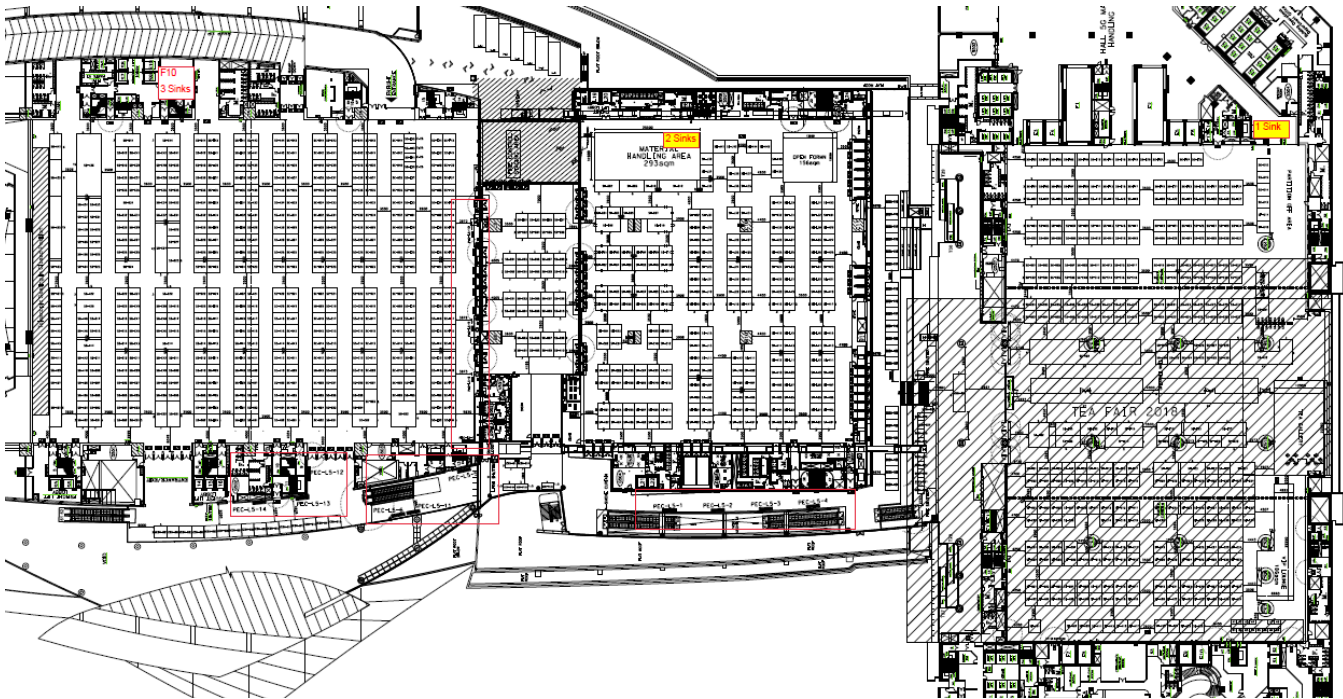

For information only, subject to change if necessary
只供參考，如有需要，隨時作出更改

..... Smoke Curtain 防煙閘

Hall 1,3 For booths located within ± 500 mm area under the smoke curtain, the maximum allowable height is 3000 mm.

展覽廳 1,3：在防煙閘下 ± 0.5 米的範圍內，(見展覽廳平面圖第 9 頁)攤位高度不得超過 3 米。

2.8 Section Plan of Exhibition Centre

Key 註解：

" / " refers to the escalator between the levels

" / " 代表來往各樓層之扶手電梯

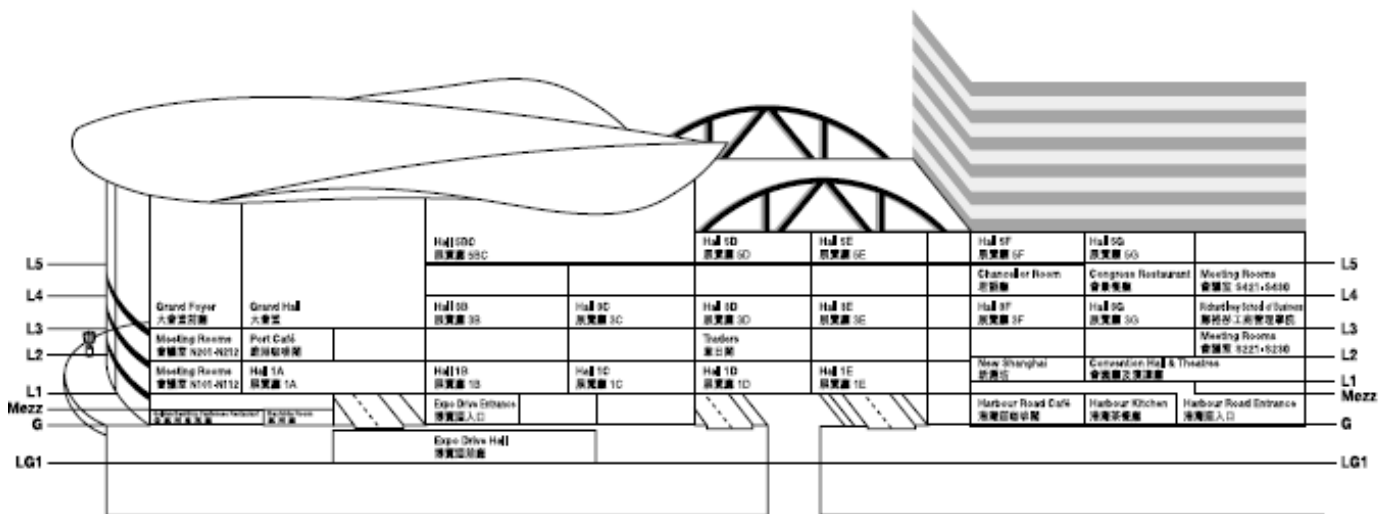

2.9 Location Map of Exhibition Centre (Wanchai Area)



2.10. Location Map of Exhibition Centre (Hong Kong Area)

